



ಭಾ. ಕೃ. ಅನು. ಪ - ಭಾರತೀಯ ತೋಟಗಾರಿಕಾ ಸಂಶೋಧನಾ ಸಂಸ್ಥೆ  
ಹೆಸರಗಟ್ಟ ಕೆರೆ ಅಂಚೆ, ಬೆಂಗಳೂರು-560 089

भा.कृ.अनु.प.- भारतीय बागवानी अनुसंधान संस्थान

हेसरघट्टा लेक पोस्ट, बेंगलूरु - 560 089

ICAR-Indian Institute of Horticultural Research

Hesaraghatta Lake Post, Bengaluru - 560 089

EPABX: 080-23086100 Extn: 218 & 217

FAX: 080-28466291 - Email: purchase.ihr@icar.gov.in



F.No.5-94/2022-23/SP/IIHR/

Dated: 06.03.2023

**NOTICE FOR INVITING TENDER THROUGH E-PROCUREMENT-2<sup>nd</sup> Call**

Online Bids are invited from interested firms under **Two bid system (Technical bid/financial bid)** for **Construction of ABI incubation facility 6mt x 03mt (RCC roof structure) at ICAR-IIHR, Bangalore**, Manual bids will not be entertained.

Tender documents may be downloaded from e-procurement website of CPPP <https://eprocure.gov.in/eprocure/app> as per the schedule given in CRITICAL DATE SHEET as under:

**CRITICAL DATE SHEET**

Tender No.	F.No.5-94/2022-23/SP/IIHR/
Name of Organization	ICAR-INDIAN INSTITUTE OF HORTICULTURAL RESEARCH, Hesaraghatta Lake Post, Bangalore
Date and Time for Issue/Publishing	06.03.2023 at 05:00 PM
Document Download/Sale Start Date and Time	06.03.2023 at 05:00 PM
Bid Submission start Date and Time	06.03.2023 at 05:00 PM
Bid Submission End Date and Time	13.03.2023 at 03:00 PM
Date and Time for Opening of Technical Bids	15.03.2023 at 10:00 AM
Address for Communication	Admn. Officer (Store Purchase), IIHR, Hesaraghatta Lake Post, Bangalore

Sd/-  
CHIEF ADMINISTRATIVE OFFICER(Sr.Grade)

INSTRUCTIONS FOR ONLINE BID SUBMISSION

1. The Tender form/bidder documents may be downloaded from the <https://eprocure.gov.in/eprocure/app>. **Online submission of Bids through Central Public Procurement Portal (<https://eprocure.gov.in/eprocure/app>) is mandatory.** Manual/Offline bids shall not be accepted under any circumstances.
2. Tenderers/bidders are requested to visit the website <https://eprocure.gov.in/eprocure/app> regularly. Any changes/modifications in tender enquiry will be intimated by corrigendum through this website only.
3. In case, any holiday is declared by the Government on the day of opening, the tenders will be opened on the next working day at the same time. The Council reserves the right to accept or reject any or all the tenders.
4. The interested Firms are required to deposit (in original) **EMD of Rs.26,000/- @ 2% of the estimated value of the work** in the shape of Demand Draft in favour of **THE DIRECTOR, ICAR, UNIT-IIHR payable at Bangalore** may be address to **Admn. Officer (Purchase), IIHR, Hessaraghatta Lake Post, Bangalore-560089** on or before **bid opening date and time as mentioned in the Critical Date Sheet.**
5. **Please note that only online Bids will be accepted. However hard copy of documents and technical brochures uploaded by the firm deposited to Admn. Officer (Purchase), IIHR, Hessaraghatta Lake Post, Bangalore-560089 on or before bid opening date and time as mentioned in the Critical Date Sheet.**
6. Bidders need not to come at the time of Technical as well as Financial bid opening at IIHR. They can view live bid opening after login on CPPP e-procurement portal at their remote end. If any dispute arises, Within Bengaluru Jurisdiction only.
7. The firms are also required to upload copies of the following documents for Technical eligibility and Evaluation:-

• Technical Bid

1. **Scanned copy of the documents Registered with PWD/CPWD/MES/Railways/PWD.**
2. **PAN Card copy**
3. **GST Number with Registration Certificate**
4. **Bank details of the firm.**
5. **Scanned copy of similar contracts to Government Departments.**
6. **Income Tax Returns for the last three years (2018-19, 19-20,20-21,21-22)**
7. **Profit and loss account & Balance Sheet which are audited & duly certified by the Chartered Accountant for the last three years.**
8. **Turnover of the business should be Rs.38.00 Lakhs per year, to be certified by**

Chartered Accountant as per Balance Sheets used for ITR filing.

9. Scanned copy of work/supply order for having successfully completed similar works during last 5 years ending last day of month previous to the one in which bids are invited should be either of the following:
  - a) Three similar completed works costing not less than Rs.5,02,782/- each
  - b) Two similar completed works costing not less than Rs.6,28,478/- each
  - c) One similar completed work costing not less than Rs.10,05,565/-  
(Similar work: Earth work, Plain cement concrete, Reinforced cement concrete, Centering, Fabrication, Stone masonry, Painting)
10. MSME or Udyog Aadhar or NSIC is a must for EMD Exemption otherwise, firms have to furnish EMD.
11. Tender acceptance letter (Annexure-V) is mandatory.
12. Latest copies of the GST returns for the current year/previous year.

• **Financial Bid:-**

- a) Price Bid as BOQ XXX.xls
- b) The estimates are made by qualified engineer of the ICAR system, and based on latest CPWD-DSR with all updates and correction slips. Firms/Contractors/Bidders should not quote too low or too high. To ensure quality materials, specification and workmanship, any tender with more than (+) or (-) 15% variation over and above or below the basic estimated cost will be summarily rejected.
- c) So, the bidders must take due care while quoting.
- d) Evaluation criteria: Tender will be awarded to the lowest quoted Firm among those firms qualified in the Technical Bid. In case, two or more firms quote the same amount in r/o all the items work together as a whole, then the tender will be awarded to the Firm which has got more average turnover in the last 3 years, based on IT returns/Profit & Loss account/Turnover duly certified by the CA and uploaded along with Tender through CPP.

Sd/-

CHIEF ADMINISTRATIVE OFFICER (Sr.Grade)

## Annexure-II

### Terms & Conditions

1. The tenderer shall quote rates, which will include the supply, installation & other incidental charges. GST, if any, should be indicated separately.
2. The rates should be quoted as per the BOQ uploaded on the CPP Portal (reference may be obtained from Annexure-III). GST, if any, should be indicated separately. It must be noted that the contract shall be awarded to the firm which fulfils all the required terms and conditions and remains L-I for **Total cost**.
3. The firm must also possess valid PAN No. & GST registration number and a copy of the same must also be enclosed with the tender document.
4. Copy of Financial year 2017-18, 2018-19, 2019-20, 20-21, 21-22, Income Tax Statement may be furnished.
5. The firm should be in existence for over 05 (Five) years in the trade with the business turnover of not less than Rs. **38 Lakhs** per annum for 2016-17, 2017-18 & 2018-19 or 2017-18, 2018-19, 2019-20, & 2020-21, 21-22. Chartered Accountant certified profit and Loss account, Balance sheet to this effect may be enclosed.
6. Modification in the tender documents after the closing date is not permissible.
7. The successful firm shall **commence work** within 10 days from the date of confirmed **work order** and if the work not completed in time then EMD shall be forfeited. The rates quoted shall be valid for one year from the date of opening of tender.
8. The contractor/bidder or his representative may contact the undersigned at **Tel. No. 080-23086100 Extn: 218 & 217** for any further clarification. No variation in terms and quality of the items/specifications shall be entertained or else EMD/Security deposit shall be forfeited.
9. The bidder is advised to visit the site of works at his own expenses and obtain all information that may be necessary for preparing the quotation. Submission of quotation is acceptance by the tenderer that he has inspected the site or he is aware of all conditions.
10. The Director, ICAR-IIHR, shall have the right to reject all or any of the offers, accept more than one offer, and assign part of the job without assigning any reason.
11. Merely quoting of lowest rates does not mean that order shall be given to that firm. The competent authority will finally decide on the basis of quality & performance of past installations.
12. The interested Firms are required to deposit (in original) an **Earnest Money Deposit of Rs.26,000/- @ 2% of the estimated value of the work** amount mentioned against item in the form of Demand Draft from any of the Commercial Bank in favour of **THE DIRECTOR, ICAR, UNIT-IIHR payable at Bangalore** may be address to **Admn. Officer (Purchase), IIHR, Hessaraghatta Lake Post, Bangalore-560089 on or before bid opening date and time as mentioned in the Critical Date Sheet**. No quotation shall be considered without the earnest money deposit. Demand draft drawn in favour of any officer other than 'THE DIRECTOR, ICAR UNIT-IIHR payable at Bangalore' will not be accepted and the tender will be rejected. The earnest money will be refunded only after the finalization of the procurement and no interest will be paid on earnest money. The request letter for refund of EMD & performance security is to be submitted by the firm.
13. Rates once finalized will not be enhanced/reduced during the currency of the contract.
14. In case, the successful bidder shows inability at any stage, after the contract is finalized and awarded, for whatsoever reason(s), to honour the contract, the earnest money /performance security deposited would be forfeited.
15. The Director, ICAR-IIHR reserves the right to cancel the contract at any time during the currency period of the contract without giving any reason.

16. The firm, to whom the tender will be awarded, will have to deposit the **performance security equal to 3% of the total quoted amount at which the Tender will be awarded within 21 days from the date of receipt of work order and the same will be retained during the Defect liability period(warranty) of One year. In the sense, for any material and execution defects, the firm has to set right the defects within 10 working days and maintain the said work.** If the services are not found to be satisfactory, the performance security is liable to be forfeited. No interest will be paid on performance security.
17. If any dispute(s) arises between IIHR and the firm with reference to the contract, IIHR will decide it and its decision will be binding on the firms.
18. Bid Validity: 180 days
19. Payment:- No advance or part payment will be given. The payment will be released after satisfactory completion of the work and certificate from the Indentor/Engineer.
20. **The supplier/firm has to submit the GST return for having remitted the GST amount paid by the institute to the concerned authority within 30 days from receipt of payment from IIHR, otherwise their EMD and SD/PS will not be released and such firms shall be blocklisted.**
21. **GST extra as applicable should be indicated separately in the column provided. Otherwise such quotes will be rejected.**

**Payment Terms: In order to facilitate for speedy settlement of payment you are requested to furnish the following details as below:**

1. **Name of the firm:**
2. **Name of the Bank:**
3. **IFSC Code of Bank:**
4. **Name of the Account & Account No.:**
5. **Branch Code:**
6. **Amount to be paid:**
7. **E-mail address of the party:**
8. **GST No. and Pan No. Copies**

‘Terms & Conditions are  
acceptable’

Dated

(Authorized signatory of the firm)

### Annexure-III

(Reference for BOQ) (To be quoted in format provided on CPP Portal)

Price bid for **Construction of ABI incubation facility 7.6mt x 06mt (RCC roof structure) at ICAR-IIHR, Bangalore.**

Sl. No.	Name of item	Quantity	Per unit price* (in figures/words) (as per BOQ)
01	<b>Construction of ABI incubation facility 6mt x 03mt (RCC roof structure) at ICAR-IIHR, Bangalore *</b>	01 Unit	

\*Annexure-VIII

- Items should be of reputed make and suitable for high end elite users
- **GST extra as applicable should be indicated separately in the column provided. Otherwise such quotes will be rejected.**
- **The work is to be done at ICAR-IIHR, Bangalore.**

**Note:** The above mentioned Financial Proposal/Commercial bid format is provided as BoQ\_XXXX/xls along with this tender document at <https://eprocure.gov.in/eprocure/app>. Bidders are advised to download this BoQ\_XXXX.xls as it is and quote their offer/rates in the permitted column and upload the same in the Financial bid. **Bidder shall not tamper/modify downloaded price bid template in any manner.** In case if the same is found to be tempered/modified in any manner, tender will be completely rejected and EMD would be forfeited and tenderer is liable to be banned from doing business with IIHR.

**Annexure-IV**

EPABX: 080-23086100 Extn: 218 & 217  
FAX: 080-28466291 - Email: purchase.iibr@icar.gov.in



**ICAR-INDIAN INSTITUTE OF HORTICULTURAL RESEARCH**

**HESSARAGHATTA LAKE POST, BANGALORE-560 089**

Name of the Firm \_\_\_\_\_

Registered/Postal Address \_\_\_\_\_

1	Permanent Account Number (PAN)	
2	GST Registration No.	
3	Bank Details	
a	Bank Name	
b	Branch Address	
c	Account Number	
d	Type of account (current/saving) MICR No.	
e	IFSC Code	

Date:

Name of the Authorized Signatory

Place:

Stamp & Signature

**TENDER ACCEPTANCE LETTER**  
(To be given on Company Letter Head)

**Date:**

To,  
The Director,  
ICAR-IIHR,  
Hesaraghatta Lake Post,  
Bangalore-560089.

Sub: Acceptance of Terms & Conditions of Tender.

Tender Reference No. \_\_\_\_\_

Name of Tender/Work:

\_\_\_\_\_  
\_\_\_\_\_  
\_\_\_\_\_

Dear Sir,

1. I/ We have downloaded/obtained the tender document(s) for the above mentioned 'Tender/work' from the web site(s) namely:

\_\_\_\_\_  
\_\_\_\_\_

As per your advertisement, given in the above mentioned website(s).

2. I/We hereby certify that I/We have read the entire terms and conditions of the tender documents from Page No. \_\_\_\_\_ to \_\_\_\_\_ (including all documents lime annexure(s), schedule(s), etc...) which form part of the contract agreement and I/We shall abide hereby the terms/conditions/clauses contained therein.
3. The corrigendum(s) issued from time to time by your department/organization too have also been taken into consideration, while submitting this acceptance letter.
4. I/we hereby unconditionally accept the tender conditions of above mentioned tender documents/corrigendum(s) in its totality/entirely.
5. I/we do hereby declare that our Firm has not been black-listed/debarred by any Govt. Department/Public sector undertaking.
6. I/we certify that all information furnished by our Firm is true & correct and in the event that the information is found to be incorrect/untrue or found violated, then your department/organization shall without giving any notice or reason therefore or summarily reject that bid or terminate the contract, without prejudice to any other rights or remedy including the forfeiture of the full said earnest money deposit absolutely.

Yours Faithfully,

(Signature of the Bidder, with Official Seal)



## **INSTRUCTIONS FOR ONLINE BID SUBMISSION**

The bidders are required to submit soft copies of their bids electronically on the CPP Portal, using valid Digital Signature Certificates. The instructions given below are meant to assist the bidders in registering on the CPP Portal, prepare their bids in accordance with the requirements and submitting their bids online on the CPP Portal.

More information useful for submitting online bids on the CPP Portal may be obtained at <https://eprocure.gov.in/eprocure/app>.

### **REGISTRATION**

- Bidders are required to enroll on the e-Procurement module of the Central Public Procurement Portal (URL <https://eprocure.gov.in/eprocure/app>.) by clicking on the link '**Online bidder Enrollment**' on the CPP Portal which is free of charge.
- As part of the enrolment process, the bidders will be required to choose a unique username and assign a password for their accounts.
- Bidders are advised to register their valid email address and mobile numbers as part of the registration process. These would be used for any communication from the CPP Portal.
- Upon enrolment, the bidders will be required to register their valid Digital Signature Certificate (class II or Class III certificates with signing key usage) issued by any certifying authority recognized by CCA India (e.g. Sify/nCode/eMudhra etc.) with their profile.
- Only one valid DSC should be registered by a bidder. Please note that the bidders are responsible to ensure that they do not lend their DSC's to others which may lead to misuse.
- Bidder then logs in to the site through the secured log-in by entering their users ID/password and the password of the DSC/e-Token.

### **SEARCHING FOR TENDER DOCUMENTS**

- There are various search options built in the CPP Portal. To facilitate bidders to search active tenders by several parameters. These parameters could include Tender ID, Organization Name, Location, Date, Value etc. There is also an option of advanced search for tenders, wherein the bidders may combine a number of search parameters such as Organization Name, Form of Contract, Location, Date, Other keywords etc. to search for a tender published on the CPP Portal.
- Once the bidders have selected the tenders they are interested in, they may download the required documents/tender schedules. These tenders can be moved to the respective 'My Tenders' folder. This would enable the CPP Portal to intimate the bidders through SMS/e-mail in case there is any corrigendum issued to the tender document.
- The bidder should make a note of the unique Tender ID assigned to each tender, in case they want to obtain any clarification/help from the Helpdesk.

### **PREPARATION OF BIDS**

- **Bidder are requested to visit the site at the institute and discuss with CTO(Works)/ACTO(Works), ICAR-IIHR, Bangalore before preparing the bid clarify the doubts and understand the requirements.**

- Bidder should take into account any corrigendum published on the tender document before submitting their bids.
- Please go through the tender advertisement and the tender document carefully to understand the documents required to be submitted as part of the bid. Please note the number of covers in which the bid documents have to be submitted, the number of documents- including the names and content of each of the document that need to be submitted. Any deviations from these may lead to rejection of the bid.
- Bidder, in advance, should get ready the bid documents to be submitted as indicated in the tender document/schedule and generally, they can be in PDF/XLS/RAR/DWF/JPG formats. Bid documents may be scanned with 100 dpi with black and white option which helps in reducing size of the scanned document.
- To avoid the time and effort required in uploading the same set of standard documents which are required to be submitted as a part of every bid, a provision of uploading such standard documents (e.g. PAN card copy, annual reports, auditor certificates etc.) has been provided to the bidders. Bidders can use 'My Space' or 'Other important Documents' area available to them to upload such documents. These documents may be directly submitted from the 'My Space' area while submitting a bid, and need not be uploaded again and again. This will lead to a reduction in the time required for bid submission process.

## **SUBMISSION OF BIDS**

- Bidder should log into the site well in advance for bid submission so that they can upload the bid in time i.e. on or before the bid submission time. Bidder will be responsible for any delay due to other technical issues.
- The bidder has to digitally sign and upload the required bid documents one by one as indicated in the tender document.
- Bidder has to select the payment option as 'offline' to pay the tender fee/EMD as applicable and enter details of the instrument.
- Bidder should prepare the EMD as per the instructions specified in the tender document. The original should be posted/couriered/given in person to the concerned official, latest by the last date of bid submission or as specified in the tender documents. The details of the DD/any other accepted instrument, physically sent, should tally with the details available in the scanned copy and the data entered during bid submission time. Otherwise the uploaded bid will be rejected.
- Bidders are requested to note that they should necessarily submit their financial bids in the Format provided and no other format is acceptable. If the price bid has been given as a standard BoQ format with the tender document, then the same is to be downloaded and to be filled by all the bidders. Bidders are required to download the BoQ file, open it and complete the white coloured (unprotected) cell with their respective financial quotes and other details (such as name of the bidder). No other cells should be changed. Once the details have been completed, the bidder should save it and submit it online, without changing the filename. If the BoQ file is found to be modified by the bidder, the bid will be rejected.
- The server time (which is displayed on the bidders' dashboard) will be considered as the standard time for referencing the deadlines for submission of the bids by the bidders, opening of bids etc. The bidders should follow this time during bid submission.
- All the documents being submitted by the bidders would be encrypted using PKI encryption techniques to ensure the secrecy of the data. The data entered cannot be viewed by unauthorized persons until the time of bid opening. The confidentiality of the bids is

maintained using the secured Socket Layer 128 bit encryption technology. Data storage encryption of sensitive fields is done. Any bid document that is uploaded to the server is subjected to symmetric, encryption using a system generated symmetric key. Further this key is subjected to asymmetric encryption using buyers/bid openers public keys. Overall, the uploaded tender documents become readable only after the tender opening by the authorized bid openers.

- The uploaded tender documents become readable only after the tender opening by the authorized bid openers.
- Upon the successful and timely submission of bids (i.e. after clicking ‘Freeze Bid Submission’ in the portal), the portal will give a successful bid submission message and a bid summary will be displayed with the bid no. and the date and time of submission of the bid with all other relevant details.
- The bid summary has to printed and kept as an acknowledgement of the submission of the bid.

#### **ASSISSTANCE TO BIDDERS**

- Any queries relating to the tender documents and the terms and conditions contained therein should be addressed to the Tender Inviting Authority for a tender or the relevant contract person indicated in the tender.
- Any queries relating to the process of online bid submission or queries relating to CPP Portal in general may be directed to the 24x7 CPP Portal Helpdesk.

\*\*\*\*

**Annexure-VII**

## Details of Works &amp; EMD

Sl. No.	Purchase of item	Qty	Earnest Money in INR	File. No. for reference
01	<b>Construction of ABI incubation facility 6mt x 03mt (RCC roof structure) at ICAR-IIHR, Bangalore.</b>	01 UNIT	Rs.26,000/-	F.No.5-94/2022-23/SP/IIHR

Note: EMD defined on to the Portal is MINIMUM. Bidder has to submit the EMD as per item for which quoting for.

**\*WORK at ICAR-IIHR, Bangalore.**

**Technical Specification for Construction of ABI incubation facility 6mt x 03mt (RCC roof structure) at ICAR-IIHR, Bangalore.**

No	Details	Unit	Qty
1	Earth work in excavation by mechanical means (Hydraulic excavator)/manual means over areas(exceeding 30 cm in depth, 1.5 m in width as well as 10 sqm on plan) including getting out and disposal of excavated earth lead upto 50 m and lift upto 1.5 m, as directed by Engineer-in-charge. All kinds of soil For wall foundation and columns	Cum	19
2	Providing and laying in position cement concrete of specified grade excluding the cost of centering and shuttering - All work up to plinth level : 1:5:10 (1 cement : 5 coarse sand (zone- III) derived from natural sources : 10 graded stone aggregate 40 mm nominal size derived from natural sources) for wall foundation, flooring and plinth protection, column footing base	Cum	7.50
3	Random rubble masonry with hard stone in foundation and plinth including levelling up with cement concrete 1:6:12 (1 cement : 6 coarse sand : 12graded stone aggregate 20 mm nominal size) upto plinth level with Cement mortar 1:6 (1 cement : 6 coarse sand)	Cum	02
4	Centering and shuttering including strutting, propping etc. and removal of form for For chajja For lintel Roof Column Roof Beam Column footing Grade beam Drain slab	Sqm Sqm Sqm Sqm Sqm Sqm Sqm Sqm	13 07 25 28 19 13 16 09
5	Steel reinforcement for R.C.C. work including straightening, cutting, bending, placing in position and binding all complete upto plinth level and above plinth level , Thermo-Mechanically Treated bars of grade Fe-500D or more, lintel, chajja, roof ,column for grade beam column footing, drain slab	Kg Kg	1,400 1,000
6	Providing and constructing concrete block masonry using 150x200x400 mm solid core compact concrete block (Grade C - 50Kg/Cm <sup>2</sup> ) in CM 1:6 including all scaffolding, curing, etc. complete For walls	Sqm	70
7	Providing and laying in position specified grade of reinforced cement concrete, excluding the cost of centering, shuttering, finishing and reinforcement - All work up to plinth level 1:2:4 (1	Cum	06

	cement : 2 coarse sand (zone-III) derived from natural sources : 4 graded stone aggregate 20 mm nominal size derived from natural sources) for grade beam, column footing , drain slab		
8	Reinforced cement concrete work in lintel beams, chajja and roof above plinth level up to floor five level, excluding the cost of centering, shuttering, finishing and reinforcement with 1:1.5:3 (1 cement : 1.5 coarse sand(zone-III) derived from natural sources : 3 graded stone aggregate 20 mm nominal size derived from natural sources) For lintel and chajja , column	Cum	3.5
9	Providing and laying in position ready mixed or site batched design mix cement concrete for reinforced cement concrete work; using coarse aggregate and fine aggregate derived from natural sources, Portland Pozzolana / Ordinary Portland /Portland Slag cement, admixtures in recommended proportions as per IS: 9103 to accelerate / retard setting of concrete, to improve durability and workability without impairing strength; including pumping of concrete to site of laying, curing, carriage for all leads; but excluding the cost of centering, shuttering, finishing and reinforcement as per direction of the engineer-in-charge; for the following grades of concrete All works above plinth level upto floor V level Concrete of M25 grade with minimum cement content of 330 kg /cum for roof	Cum	08
10	Providing Cement plaster 1:3 (1 cement: 3 coarse sand) finished with a floating coat of neat cement. 12 mm cement plaster	Sqm	195
11	Providing and applying white cement based putty of average thickness 1 mm, of approved brand and manufacturer, over the plastered wall surface to prepare the surface even and smooth complete. (Asian Tractor / Jonson Nicholson / Berger)	Sqm	57
12	Applying one coat of water thinnable cement primer of approved brand and manufacture on wall surface Water thinnable cement primer	Sqm	147
13	Wall painting with acrylic emulsion paint, having VOC (Volatile Organic Compound) content less than 50 grams/ litre, of approved brand and manufacture, including applying additional coats wherever required, to achieve even shade and colour. Two coats (Asian Tractor / Jonson Nicholson / Berger )	Sqm	57
14	Finishing walls with Acrylic Smooth exterior paint of required shade New work (Two or more coat applied @ 1.67 ltr/10 sqm over and including priming coat of exterior primer applied @ 2.20 kg/10 sqm) (Asian Tractor / Jonson Nicholson/Berger)	Sqm	90
15	Steel work in built up tubular (round, square or rectangular hollow tubes etc.) trusses etc., including cutting, hoisting, fixing in position and applying a priming coat of approved steel primer, etc. complete. Angles and 10 mm solid rod for window grill	Kgs	330

16	Painting with synthetic enamel paint of approved brand and manufacture of required colour to give an even shade Two or more coats on new work over an under coat of suitable shade with ordinary paint of approved brand and manufacture	Sqm	30
17	Providing and fixing pressed steel door frames conforming to IS: 4351, manufactured from commercial mild steel sheet of 1.60 mm thickness, including hinges, jamb, lock jamb, bead and if required angle threshold of mild steel angle of section 50x25 mm, or base ties of 1.60 mm, pressed mild steel welded or rigidly fixed together by mechanical means, including M.S. pressed butt hinges 2.5 mm thick with mortar guards, lock strike-plate and shock absorbers as specified and applying a coat of approved steel primer after pre-treatment of the surface as directed by Engineer- in-charge Fixing with adjustable lugs with split end tail to each jamb	Rmt	11.2
18	Providing and fixing ISI marked flush door shutters conforming to IS2202 (Part I) non-decorative type, core of block board construction with frame of 1st class hard wood and well matched commercial 3 ply veneering with vertical grains or cross bands and face veneers on both faces of shutters 30 mm thick including ISI marked Stainless Steel butt hinges with necessary screws	Sqm	4.62
19	Providing and fixing bright finished brass hanging type floor doorstopper with necessary screws, etc. complete	Sqm	02
20	Providing and fixing bright finished brass tower bolts (barrel type) with necessary screws etc. complete 150x10 mm	Each	04
21	Providing and fixing bright finished brass door latch with necessary screws etc. complete 250x16x5 mm	Each	04
22	Providing and fixing aluminium handles, ISI marked, anodised (anodic coating not less than grade AC 10 as per IS : 1868) transparent or dyed to required colour or shade, with necessary screws etc. complete 125 mm	Each	04
23	Providing and fixing Chlorinated Polyvinyl Chloride (CPVC) pipes, having thermal stability for hot & cold water supply, including all CPVC plain & brass threaded fittings, including fixing the pipe with clamps at 1.00 m spacing. This includes jointing of pipes & fittings with one step CPVC solvent cement and testing of joints complete as per direction of Engineer in Charge 20 mm nominal dia Pipes	Rmt	30
24	Providing and fixing wash basin with C.I. brackets, 15 mm C.P. brass pillar taps, 32 mm C.P. brass waste of standard pattern, including painting of fittings and brackets, cutting and making good the walls wherever require White Vitreous China Wash basin size 630x450 mm with a pair of 15 mm C.P. brass pillar taps	Each	02
25	Providing and fixing white vitreous china pedestal for wash basin completely recessed at the back for the reception of pipes and fittings	Each	02

26	Supplying and fixing of CPVC gate valve 20mm as per standards	Each	02
27	Supplying and fixing Triple layer PVC overhead tank with necessary bush , fittings etc., complete as required at site 1,000 lts tank	Lts	1,000
28	Supplying and laying fixing PVC pipes (6kg/cm <sup>2</sup> -ISI-Finolex/Supreme/Kisan/Prince/Canara/Ashirvad) with all required collars, bends, elbows, tees, sockets, bush with pvc solvent etc . including providing PVC clamps at every one meter, complete as required at site 100mm sewer line and rain water down pipe	Rmt	24
29	Banking excavated earth in layers not exceeding 20 cm in depth, breaking clods, watering, rolling each layer with ½ tonne roller, or wooden or steel rammers, and rolling every 3rd and top-most layer with power roller of minimum 8 tonnes and dressing up, in embankments for roads, flood banks, marginal banks, and guide banks etc., lead upto 50 m and lift upto 1.5 m all kinds of soil	Cum	15
30	Filling available excavated earth (excluding rock) in trenches, plinth, sides of foundations etc. in layers not exceeding 20cm in depth, consolidating each deposited layer by ramming and watering, lead up to 50 m and lift upto 1.5 m.	Cum	10
31	Constructing masonry Chamber 30x30x50 cm inside, in brick work in cement mortar 1:4 (1 cement :4 coarse sand) for stop cock, with C. I. surface box 100x100 x75 mm (inside) with hinged cover fixed in cement concrete slab 1:2:4 mix (1 cement : 2 coarse sand : 4 graded stone aggregate 20 mm nominal size), i/c necessary excavation, foundation concrete 1:5:10 ( 1 cement : 5 fine sand	Each	04
	: 10 graded stone aggregate 40mm nominal size ) and inside plastering with cement mortar 1:3 (1 cement : 3 coarse sand) 12mmthick, finished with a floating coat of neat cement complete as per standard design With common burnt clay F.P.S.(non modular) bricks of class designation 7.5		
32	Pointing on stone work with cement mortar 1:3 (1 cement : 3 fine sand) : Flush/ Ruled pointing	Sqm	12
33	Providing roof water proofing with three layer acrylic based membrane treatment including cleaning of existing surface, with acrylic water proofing sealer, primer coat, water proofing coating, complete as per manufacturer's specifications and directions. For roof	Sqm	35
34	Providing and laying damp-proof course 50mm thick with cement concrete 1:2:4 (1 cement : 2 coarse sand (zone-III) derived from natural sources : 4 graded stone aggregate 20mm nominal size derived from natural sources).	Sqm	18
35	Providing and laying vitrified floor tiles in different sizes (thickness to be specified by the manufacturer) with water absorption less than 0.08% and conforming to IS: 15622, of approved make, in all colours and shades, laid on 20mm thick cement mortar 1:4 (1 cement : 4	Sqm	21



	coarse sand), jointing with grey cement slurry @ 3.3 kg/ sqm including grouting the joints with white cement and matching pigments etc., complete Size of Tile 600x600 mm		
36	Providing and fixing aluminium work for doors, windows, ventilators and partitions with extruded built up standard tubular sections/ appropriate Z sections and other sections of approved make conforming to IS: 733 and IS: 1285, fixing with dash fasteners of required dia and size, including necessary filling up the gaps at junctions, i.e. at top, bottom and sides with required EPDM rubber/neoprene gasket etc. Aluminium sections shall be smooth, rust free, straight, mitred and jointed mechanically wherever required including cleat angle, Aluminium snap beading for glazing / paneling, C.P. brass / stainless steel screws, all complete as per architectural drawings and the directions of Engineer-in-charge. (Glazing, paneling and dash fasteners to be paid for separately) Powder coated aluminium (minimum thickness of powder coating 50 micron)	Kg	89
37	For shutters of doors, windows & ventilators including providing and fixing hinges/ pivots and making provision for fixing of fittings wherever required including the cost of EPDM rubber / neoprene gasket required (Fittings shall be paid for separately) Powder coated aluminium (minimum thickness of powder coating 50 micron)	Kg	60
38	Providing and fixing glazing in aluminium door, window, ventilator shutters and partitions etc. with EPDM rubber / neoprene gasket etc. complete as per the architectural drawings and the directions of engineer-in-charge . (Cost of aluminium snap beading shall be paid in basic item): With float glass panes of 4.0 mm thickness (weight not less than 10kg/sqm) pinhead glass	Sqm	12
39	Providing and fixing 09 mm thick pre laminated particle board flat pressed three layer or graded wood particle board conforming to IS:12823 Grade I Type II, in panelling fixed in aluminum doors, windows shutters and partition frames with C.P. brass / stainless steel screws etc. complete as per architectural drawings and directions of engineer-in-charge. Pre-laminated particle board with decorative lamination on both sides	Sqm	06
40	Structural steel work riveted, bolted or welded in built up sections, trusses and framed work, including cutting, hoisting, fixing in position and applying a priming coat of approved steel primer all complete MS round pipe for parapet for safety and for suitable design simple ladder for tank repairs and cleaning purposes	Kg	200
41	Painting with synthetic enamel paint of approved brand and manufacture of required colour to give an even shade Two or more coats on new work over an under coat of suitable shade with ordinary paint of approved brand and manufacture	Sqm	15
	<b>ELECTRICAL WORK</b>		

42	Wiring for light point/ fan point/ exhaust fan point/ call bell point with 1.5 sq.mm FRLS PVC insulated copper conductor single core cable in surface / recessed medium class PVC conduit, with modular switch, modular plate, suitable GI box and earthing the point with 1.5 sq.mm FRLS PVC insulated copper conductor single core cable etc. as required. Stepped type Modular Fan regulator (2 module)	Point         Each	6 Points         2 Nos
43	Wiring for light/ power plug with 2X4 sq. mm FRLS PVC insulated copper conductor single core cable in surface/ recessed medium class PVC conduit along with 1 No. 4 sq. mm FRLS PVC insulated copper conductor single core cable for loop earthing as required.  S.P. 5/6 amps, one way modular switch, ISI marked. S.P. 15/16 amps, one way modular switch, ISI marked. 3 pin 5/6 amps modular socket outlet, ISI marked. 6 pin 15/16 amps modular socket outlet, ISI marked. Modular base & cover plate for 6 module	Meter    Each Each Each Each Each	65    8 8 8 8 8
44	Wiring for light/ power plug with 4X4 sq. mm FRLS PVC insulated copper conductor single core cable in surface/ recessed steel conduit along with 2 Nos. 4 sq. mm FRLS PVC insulated copper conductor single core cable for loop earthing as required.	Meter	25 RMT

45	Supplying and fixing 30 A, 415 V, TPN Industrial type socket outlet, with 4 pole and earth, metal enclosed plug top along with 30 A "C" curve, TPNMCB, in sheet steel enclosure, on surface or in recess, with chained metal cover for the socket out let and complete with connections, testing and commissioning etc. as required. (5 Way)	Each	2 Nos
46	Supplying and fixing of 18-20 W LED tube light fittings as required at site.	Each	4 Nos
47	Supplying and fixing of Ceiling Fan as required at site.	Each	2 Nos
48	Supplying and fixing of 100 Amps open type 4 way copper Bus bar box of size 12" X 12" with cable termination by using copper lugs.	Each	1 Set.
49	Supplying and fixing following way, single pole and neutral, sheet steel, MCB distribution board, 240 V, on surface/ recess, complete with tinned copper bus bar, neutral bus bar, earth bar, din bar, interconnections, powder painted including earthing etc. as required. (But without MCB/RCCB/Isolator) 12 way , Single Door/Double door.	Each	1 No
50	Supplying and fixing 5 A to 32 A rating, 240/415 V, 10 kA, "C" curve, miniature circuit breaker suitable for inductive load of following poles in the existing MCB DB complete with connections, testing and commissioning etc. as required.  10 A Single pole  20 A Single pole  32 A TP&N	Each  Each  Each	2 Nos  2 Nos  3 Nos
51	Earthing with copper earth plate 600 mm X 600 mm X 3 mm thick including accessories, and providing masonry enclosure with cover plate having locking arrangement and watering pipe of 2.7 metre long etc. with charcoal/ coke and salt as required.  Providing and laying earth connection from earth electrode with 6 SWG dia G.I. Wire in 15 mm dia G.I. pipe from earth electrode including connection with G.I. thimble excavation and re-filling as required.	Set  Meter	1 No  12
52	Supplying and laying of following sizes of <b>PVC insulated Aluminum conductor wired Armored UG cable</b> in DWC Pipe double walled corrugated high density poly ethylene pipe having corrugation on the outer wall 50 mm and plain surface inner wall of 55 mm sizes	Mtrs	50 RMT

	conforming to <b>IS14930</b> , with necessary DWC fitting for protection of 1.1 KV grade UG Cable directly in ground at a depth of 2 feet including excavation and refilling the trench (including earthing and end termination) etc. as required at the site. (V guard/ Havel's/Poly cab/Ashirvad with ISI). <b>25 sq mm x 4 core.</b>		
--	---	--	--

**Sd/-  
CAO(Sr.Grade)**

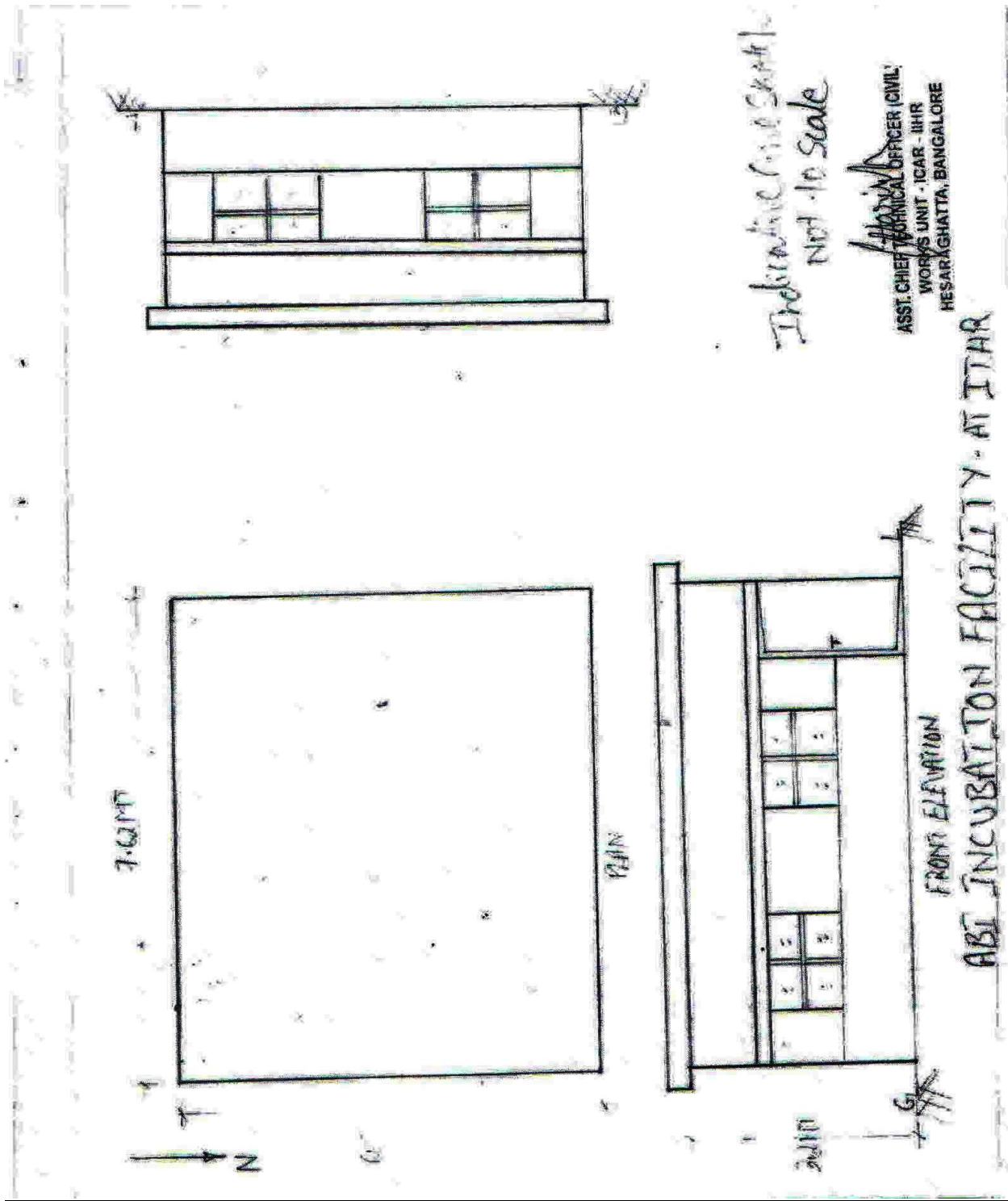

Sd/-  
CAO (Sr. Grade)